

SMART WIRELESS BASE

»» SMART MONITORING & TESTING SOLUTIONS



SMARTBASE^{WS}

WIRELESS BASE AND SENSOR FOR
INDOOR USE

- » INDOOR USE
- » SENSING CAPABILITY
- » CONTROL CAPABILITY
- » GSM/GPRS CONNECTIVITY
- » LAN/WLAN



➤ FLEXIBLE SENSING AND CONTROL SOLUTION

PRODUCT DESCRIPTION

The SmartBase^{WS} is a stand-alone gateway that provides long-distance data-transfer per USB UMTS-stick, LAN or WLAN from the monitoring site to the end-user. The SmartBase^{WS} is designed to withstand harsh environments (separate housing needed) and multiple power supply options guarantee its worldwide application. To allow for fully autonomous operation in applications where no electric power is available, the SmartBase^{WS} could be equipped with solar cells and secondary batteries. It supports USB, Ethernet, RS232, RS485, SPI, I²C and UART. The SmartBase^{WS} could operate as Stand-alone solution with database, web server and user-interface (via LAN/WLAN) to analyse data.

It is designed also for active control (provision of alarms, switching device for climate control etc.) via the RS485 or One-Wire-Interface.

Due to featuring the full sensing capacity of the Smartmote^{WS}, it could operate as a self-sufficient sensing and control unit with maximum reliability.

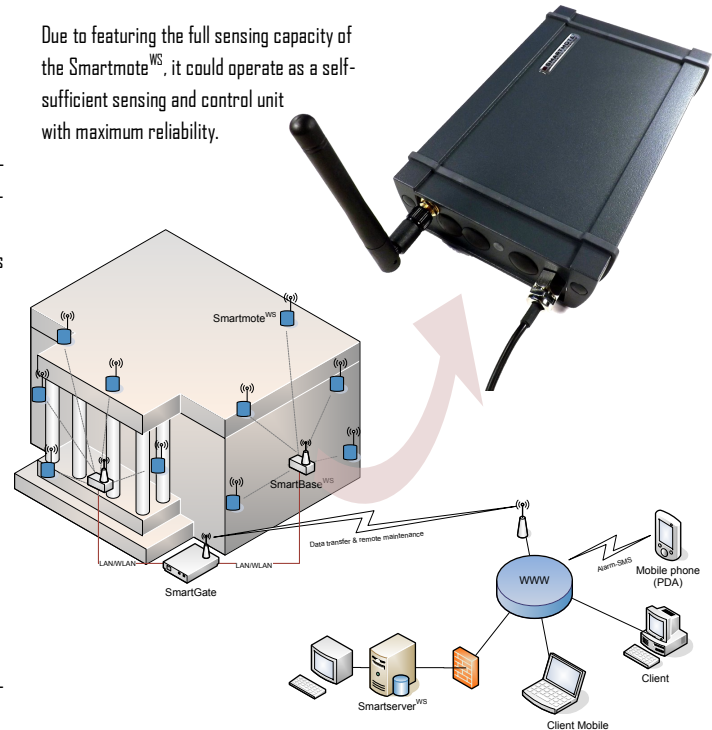

➤ KEY FEATURES

MAIN SPECIFICATIONS

- » Broadcom BCM2835 CPU ARM1176JZF-S (700 MHz)
- » 512 MB RAM for applications
- » Data flash extension SD/MMC/SDIO
- » 2.4 GHz transceiver for wireless sensor network data transmission
- » Embedded Linux onboard (as default, Kernel 2.6.x)
- » 5V power supply (USB optionally)
- » Operating Temperature Range -25 to +70°C (non condensing)
- » Dimensions 162 x 98.5 x 38 mm³ (in case)
- » Weight 1.0 kg (in case)

PERIPHERALS

- » USB Host Connector (max. 500mA)
- » GPIO
- » LAN (10/100Mbit)
- » WLAN (via USB stick)
- » GPRS/UMTS (via USB stick)
- » RS232 (Screw-type terminal)
- » RS485 (Screw-type terminal)
- » Internal Pin-Connectors for small optional IO-Interface Board (SPI, I2C, RS 485)
- » Internal Pin-Connector for programming / debugging
- » Internal Pin-Connector for JTAG
- » SMA Reverse Antenna Connector for Wireless Sensor-Net Communication at 2.4GHz
- » DCF 77 clock or time synchronisation via web



TTI GMBH - TGU SMARTMOTE

PFAFFENWALDRING 4
70569 STUTTGART
GERMANY

TEL.: +49 711 685 66789
FAX: +49 711 685 66818
E-MAIL: INFO@SMARTMOTE.DE

SMARTMOTE
MONITORING & TESTING